

# Hisense

# QUICK SETUP GUIDE

Before using the TV, please read this guide thoroughly and retain it for future reference.

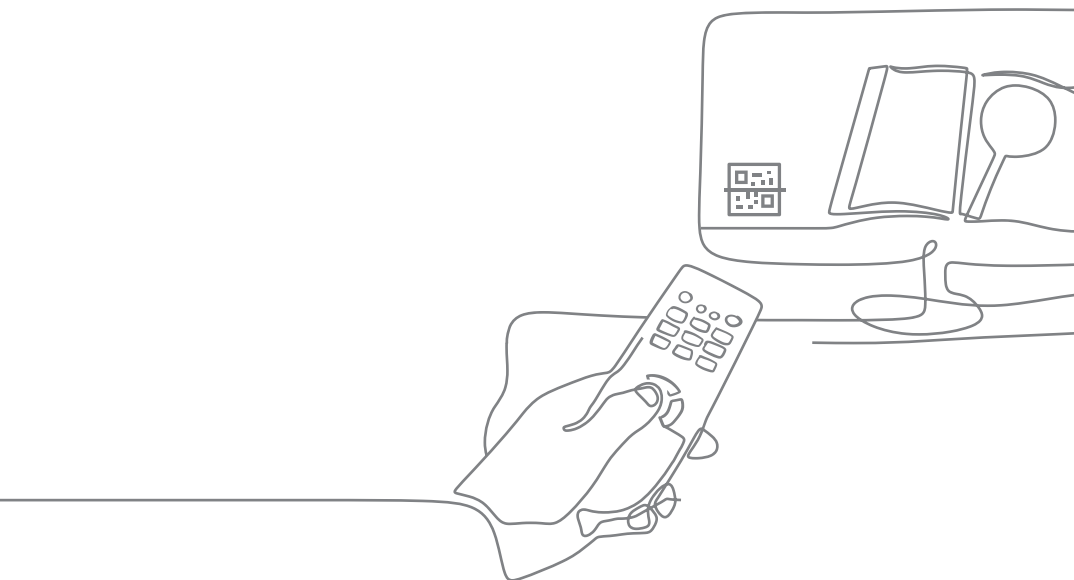

1415324 ES-A24511H-1

**English**

Congratulations on the purchase of your Hisense TV! If you would like to know 'all things Hisense', contact us using the support info:

The model and serial number of the TV is located on the back and/or on one side of the TV. We recommend that you record this if you ever need service.

Country	U.S.A	CANADA	MEXICO
Customer Care Center	<ul style="list-style-type: none"><li>• <b>Phone:</b> 1-888-935-8880</li><li>• <b>Hours of Operation:</b> Monday - Friday: 9 AM to 9 PM EST Saturday - Sunday: 9 AM to 6 PM EST</li><li>• <b>Service Email:</b> Service@hisense-usa.com</li></ul> <p><b>USA:</b> Hisense USA Corporation 105 Satellite BLVD Suite I, Suwanee, GA 30024</p>	<ul style="list-style-type: none"><li>• <b>Phone:</b> 1-855-344-7367</li><li>• <b>Hours of Operation:</b> Monday - Friday: 8 AM to 8 PM EST Saturday - Sunday: 9 AM to 6 PM EST, Federal holidays excluded</li><li>• <b>Service Email:</b> canadasupport@hisense.com</li></ul> <p><b>CANADA:</b> Hisense Canada Co., Ltd 2550 Meadowvale Boulevard, Unit 1 Mississauga, ON, Canada L5N 8C2</p>	<ul style="list-style-type: none"><li>• <b>Phone:</b> 800-008-8880</li><li>• <b>Hours of Operation:</b> Monday - Friday: 9 AM to 9 PM Saturday: 9 AM to 3 PM</li><li>• <b>Service Email:</b> servicio@hisense.com.mx</li></ul> <p><b>MEXICO IMPORTER:</b> Hisense Mexico S. de R.L. de C.V. Blvd. Miguel de Cervantes Saavedra No 301 Torre Norte Piso 2, Col. Ampliación Granada Miguel Hidalgo, Ciudad de México, C.P. 11520</p>
Hisense Support Page	<p><a href="http://www.hisense-usa.com/support/">http://www.hisense-usa.com/support/</a></p> 	<p><a href="http://www.hisense-canada.com/support/">http://www.hisense-canada.com/support/</a></p> 	<p><a href="https://hisense.com.mx/support/">https://hisense.com.mx/support/</a></p>  <p>*Scan to download user manual</p>
Register your TV	<p><a href="http://www.hisense-usa.com/support/register">http://www.hisense-usa.com/support/register</a></p> 	<p><a href="http://www.hisense-canada.com/support/productReg.asp">http://www.hisense-canada.com/support/productReg.asp</a></p> 	<p><a href="https://hisense.com.mx/support/register">https://hisense.com.mx/support/register</a></p> 

## Disclaimer

Disclaimer: Subscriptions or other payments may be required to access content through some applications. Some or all of the included or downloaded application services in this Hisense device may not function depending on the Internet connection, local limitations of included applications or other reasons outside of Hisense's control. HISENSE EXPRESSLY DISCLAIMS RESPONSIBILITY FOR ANY APPLICATION SERVICE FROM FUNCTIONING AT ANY TIME, FOR CONTENT IN ANY APPLICATION SERVICE, FOR DISRUPTIONS OF SERVICE, LOCAL OR REGIONAL LIMITATIONS, WARRANTIES OF TITLE, NO INFRINGEMENT, AND FOR IMPLIED WARRANTIES OF MERCHANTABILITY OR FITNESS FOR A PARTICULAR PURPOSE. By purchasing this device, you accept such Disclaimer without any claim on Hisense at any time.

# Find what you want

This TV is equipped with this quick setup guide and embedded E-Manual (⚙️ > **Settings > Help & Feedback > E-Manual**).

On the website ([www.hisense.com](http://www.hisense.com)), you can get the User Manual.

## E-Manual support functions



**QR Code**

Scan to open the E-Manual on your mobile device.



**Search**

Find the help you are looking for.

### *This Quick Setup Guide supports the following models:*

**55U8QG / 55U88QG / 65U8QG / 65U88QG / 75U8QG / 75U88QG / 85U8QG / 85U88QG / 100U8QG / 100U88QG**

## What's in the box

Your Hisense TV comes with the following items:

- TV
- power cord
- remote control
- 2 base stand (100")(254.0cm)
- 1 base stand (including 2 parts)(55"/65"/75"/85")(139.7cm/165.1cm/190.5cm/215.9cm)
- 10 screws (8 screws in the accessory bag; 2 screws in the base stand Part A)(55"/65"/75"/85")(139.7cm/165.1cm/190.5cm/215.9cm)
- Quick Setup Guide (this document)
- 1 set of AA or AAA (1.5Vcc) batteries
- Important Safety Information and Warranty Card
- 4 screws (100")(254.0cm)

### NOTE:

- The accessories may be different from the list above due to different models, countries/regions, please refer to the actual accessory bag.

### IMPORTANT:

To prevent accidentally discarding items that came with your TV, be sure to **check ALL of the foam** in the carton box.

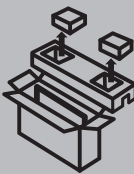

- Please check foam for accessories before discarding.
- Veuillez vérifier la mousse pour qu'il n'y ait pas d'accessoires avant de la jeter.
- Antes de desechar la espuma, asegúrese de retirar todos los accesorios.

**Disclaimer:** This Quick Setup Guide is intended as a general guideline to help you set up your TV. Images throughout this document are for illustrative purposes only and may differ from the actual product.

# Getting started

## Step 1. Attach stand or mount

Before you start using your TV, attach your TV stand or mount it on the wall.

### CAUTION:

- Disconnect the AC power cord before installing a stand or a wall mount bracket.
- The LED display on your TV is fragile. Make sure the TV screen is not scratched or damaged by hard objects or from pressure.
- After the installation is completed, make sure the TV is steady on a table or firmly attached to a wall mount, before removing all protective film, if any.

## Attach the TV stand

Follow the illustrations and textual instructions below to complete the installation steps:

**55"/65"/75"/85"(139.7cm/165.1cm/190.5cm/215.9cm)**

1. Take out base stand(including Part A and Part B), screws and side cushions. Place the side cushions as the illustration shows below.

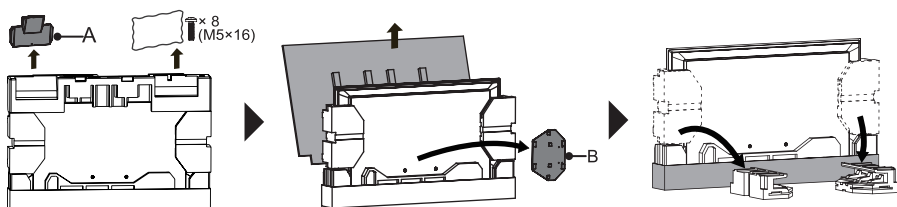

2. Two people stand on each side of the TV. Hold the side of the TV with one hand and hold the bottom with the other hand. Lift and move the TV vertically to the side cushions. Do not pinch the screen when hold the TV.

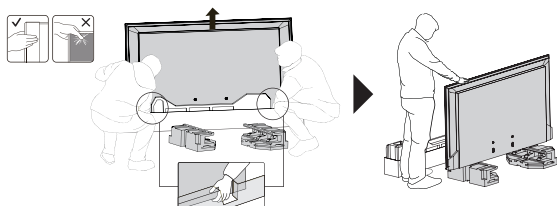

3. Take out the base stand Part A and open it from top, then separate it into Part a1 and Part a2. And you will find two M4x8 screws.

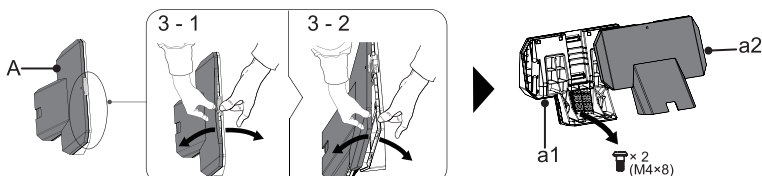

4. Secure Part a1 to base stand Part B with four M5×16 screws tightly.

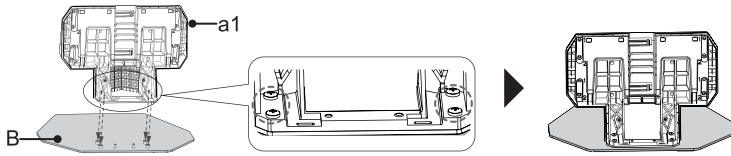

5. Secure the two M4×8 screws to screw holes on the back of TV as the illustration shows.

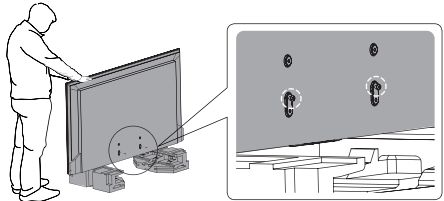

6. Hang the assembled Part a1 and Part B to the two M4×8 screws you have secured to the TV, then secure the assembled part to TV with four M5×16 screws. You can adjust the height of base stand to H1 or H2. For H1, secure screws to four hole 1. For H2, secure screws to four hole 2.

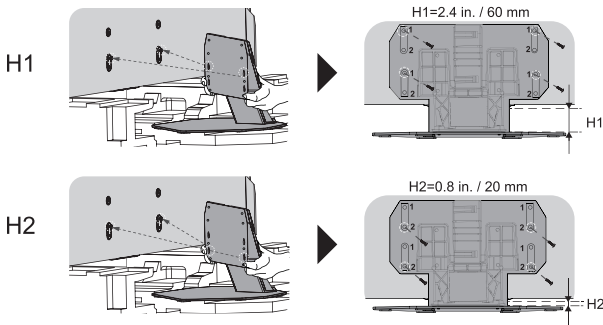

**NOTE:** Keep the television vertically when you remove the base stand. If you place the TV face down, the base stand may fall down on your feet while removing it.

7. You can tidy the cables into Part a1.

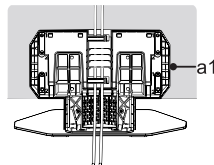

8. Place Part a2 on Part a1 and assemble them together. Then tap the four sides of the Part a2.

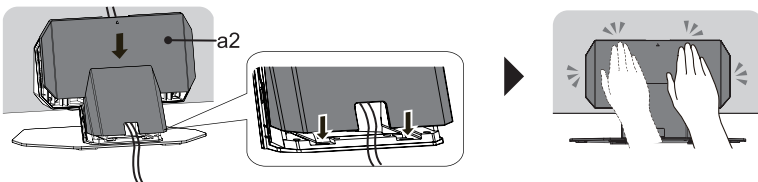

## 100"(254.0cm)

**NOTE:** Three or more persons are needed to install the TV. One person holds the TV to prevent tipping through the whole installation process.

1. One person holds the side of the TV, and the others remove the side cushions. Do not pinch the screen when hold the TV.
2. Insert the TV base stands into the bottom slots on your TV. Use the screws provided to secure each base stand tightly.
3. It takes three persons to transport the TV. The weight of TV with base stands is 140.0 lbs (63.5 kg), the furniture where the TV is placed should be tough enough to support. Please make sure the width of the furniture is above 18.9 inches (480 mm).

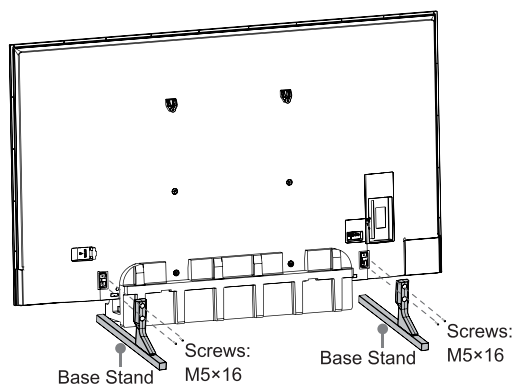
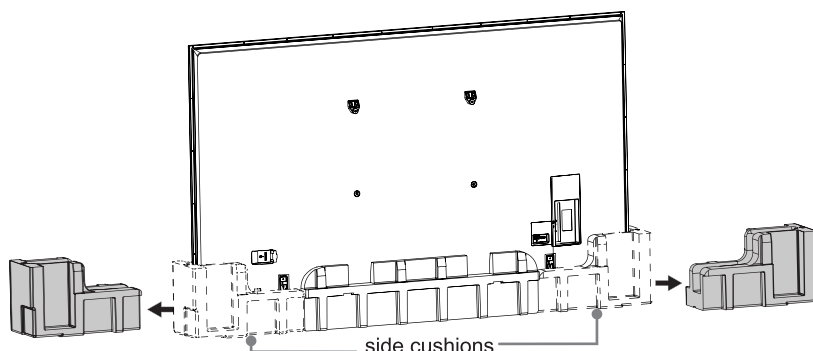

## Attach cable clamps and manage cable

(only for 75"/85"(190.5cm/215.9cm))

1. Tear off the sticker at the back of cable clamps, paste cable clamps into the holes in the cable raceway.

**NOTE:** Make sure the open-ended part of the cable clamp is positioned at the middle of cable raceway.

2. Manage cables and power cord with cable clamps.

### CAUTION:

**⚠ Before installing the wall mount on the wall, make sure that you have connected and managed power cord and all cables you need.**

75"(190.5cm)

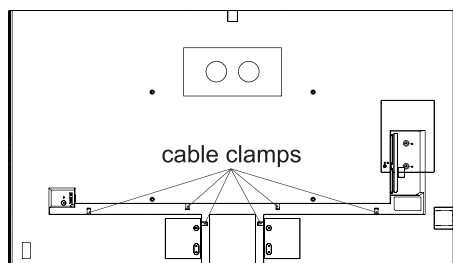

85"(215.9cm)

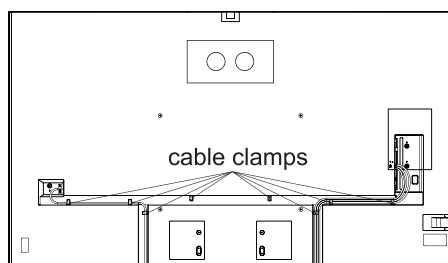

## Attach the wall mount bracket (not included)

55"/65"/75"/85"  
(139.7cm/165.1cm/190.5cm/215.9cm)

Before you begin the third-party manufacturer instructions, be sure to do the following things:

1. Place the TV on a clean, safe and cushioned surface.
2. Remove the TV stand if you have already attached it.
3. Place spacers (not included) in the corresponding bracket holes.

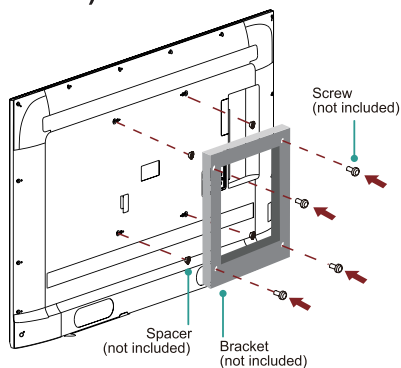

100"(254.0cm)

Before you begin the third-party manufacturer instructions, be sure to do the following things:

- 1. Keep the television vertically on the cushions. The TV weight with base stands is 140.0 lbs (63.5 kg), make sure the wall is tough enough before hanging the TV.
- 2. Remove the TV stand if you have already attached it.
- 3. Place spacers (not included) in the corresponding bracket holes.

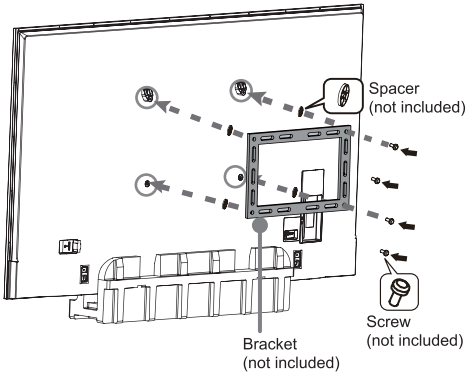

CAUTION:

- Follow instructions provided with the wall mount bracket. If it is not correctly mounted, the TV may fall and cause property damage or personal injury.
- When you attach the mount, be sure to use spacers (provided by the third-party manufacturer) between the TV and the bracket.
- To prevent internal damage to the TV and to ensure it is mounted securely, be sure to use fixing screws (not included) that are 9.5 - 11.5 mm(55"/65")(139.7cm/165.1cm) or 11.0 - 13.0 mm(75"/85"/100")(190.5cm/215.9cm/254.0cm) in length when measured from the attaching surface of the rear cover.

9.5 - 11.5 mm(55"/65")(139.7cm/165.1cm)  
11.0 - 13.0 mm(75"/85"/100")(190.5cm/215.9cm/254.0cm)

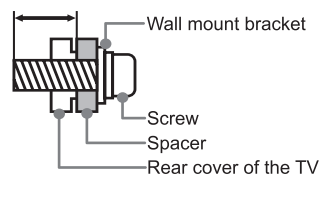
	Wall mount hole pattern(mm)	400 × 400 (55"/65")(139.7cm/165.1cm) 600 × 400 (75"/85")(190.5cm/215.9cm) 800 × 400 (100")(254.0cm)
	Wall mount screw size	M6 (55"/65")(139.7cm/165.1cm) M8 (75"/85"/100")(190.5cm/215.9cm/254.0cm)
	Number of wall mount screw	4

- We do not recommend hanging the TV on a slanted wall, and when wall mounting make sure your television remains parallel to the wall and does not lean forward.

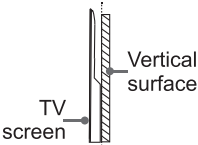



NOTE:

- If installed on a ceiling or slanted wall, or the television installed is not parallel to the wall, the television may fall and result in property damage or severe personal injury.
- If you have additional questions, please contact the wall mount manufacturer or the retailer from which you purchased the TV.
- The diameter and length of the screws differ depending on the wall mount bracket model.

## Step 2. Connect devices to your TV

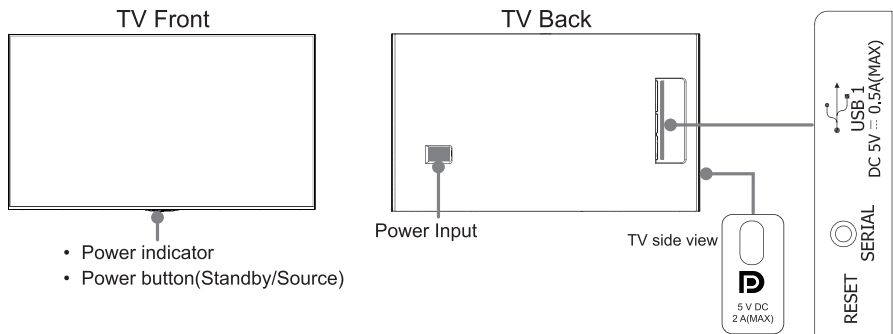
Check to ensure that you have connected right cables for right ports securely. Loose connections can affect the quality of the picture image and color.





<b>Power indicator</b>	The light is white in standby mode.
 <b>Power button (Standby/Source)</b>	When the TV is in standby mode, quick press the power button, and TV will be turned on. When the TV is on, quick press the power button to call up the menu: <ul style="list-style-type: none"><li>• Quick press to change the selection.</li><li>• Long press to confirm your selection.</li></ul>
<b>SERIAL</b>	Connect the serial cable to PC. You can input serial command on PC to control the TV, such as turn on/off the TV, select an input source or adjust the OSD menu, etc.
<b>ANT/CABLE</b>	Connect an outdoor VHF/UHF antenna.
<b>HDMI</b>	Connect a High Definition Multimedia Interface (HDMI) cable from an external device.
<b>AV IN</b>	Connect a composite video cable and left-right audio cables from an external AV device.
<b>HEADPHONE / </b>	Connect headphones to hear audio from the TV. Headphones with microphones are not supported.
<b>RESET</b>	Power off / restart (quick press) Reset your TV back to the factory setting (long press for 5 seconds)
<b>USB</b>	Connect a USB device for browsing photos, music and movies. The rate of speed of USB 3.0 port 10 times faster than the USB 2.0 port. NOTE: You can still plug a USB 2.0 device into a USB 3.0 port; however, the rate of speed will not be as fast. USB 3.0 devices are also backwards compatible with USB 2.0 ports.
<b>LAN</b>	Connect an Ethernet cable to access a network or the Internet. The TV also has a wireless connectivity feature.
<b>DIGITAL AUDIO OUT</b>	Connect an optical cable from an external digital audio system.
<b>DisplayPort over USB Type-C</b>	DP (DisplayPort™) is a display input interface. Connect a Full-Featured Type-C standard cable to PC or smart device to use your TV as a monitor. NOTE: In case you connect DP port with a Type-C cable or converter adaptor that is not fully compatible with DP standard, DP function may not work.

### Step 3. Get to know controls

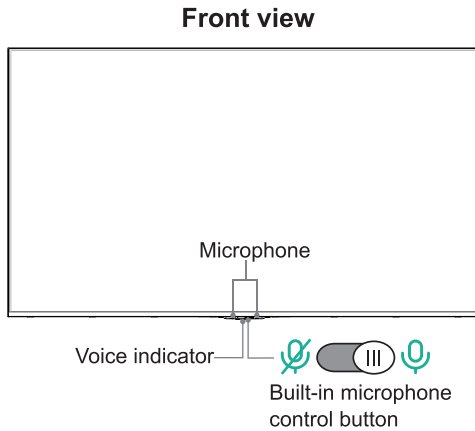
#### Control on the TV



















The Google Assistant can answer your questions or help you change TV configuration. Before using this function, connect the TV to the Internet and set up Google TV.

- How to use the Google Assistant function via the control button on your TV:
  1. Switch the button to [  ] to turn on built-in microphone.
  2. Pair the remote first, press  button to select “Yes, I’m in”. Or press  button and select **Settings > Accounts & Profiles > Google Assistant** to turn on the **Hands-free Mic** switch.
  3. Start a conversation by saying “Hey Google”, and the dialog bar appears at the top of the TV screen. At the same time, voice indicator illuminate.
  4. Continue speaking, such as “What’s the weather” or “volume up”.

**NOTE:** The Google Assistant and some features are available on limited country/region/language.

# Get your remote ready

The following table shows the buttons on your remote control and describes what they are for.

BUTTON	DESCRIPTION
	Power on/off
	Microphone / Indicator
	Change TV input source
	Google Assistant of TV
	Accounts & Sign In or switch profile
	Access the settings (direct or through the dashboard in GTV) from any place in the system
^ / v / < / >	
	D-pad (up/down/left/right navigation buttons)
OK	Confirmation button
	Return to the previous place in the menu or app
	Press to display the Home screen
	Enter to Live tab in launcher/Display the Electronic Program Guide(if support)/Return to Live TV*
+ VOL — ^ VOL v	Volume (up/down)
^ CH v	Channel (up/down)
 / 	Press to mute or restore sound Press and hold to display Accessibility menu
MENU / ≡	Press to enter Menu
	Media content control function buttons
123	Enter Channels/input numbers and special function buttons
App	Quick access buttons to applications
	Custom button to launch input or apps quickly
	Fast access to all applications
	Enter to the media center

**NOTE:**

- Buttons listed here are for reference only. Actual remote control may vary depending on model, country.
- \* Pressing the button in different scenarios will have different responses.

## Insert the batteries

1. Take off the back cover to open the battery compartment of the remote control.
2. Insert two AA or AAA(1.5Vcc) size batteries. Make sure to match the (+) and (-) ends of the batteries with the (+) and (-) ends indicated in the battery compartment.
3. Restore the battery compartment cover.





## Important information about the remote and batteries

- Discard batteries in a designated disposal area. Do not throw them into a fire.
- Remove old batteries immediately to prevent them from leaking into the battery compartment.
- If you do not intend to use the remote control for a long time, then remove the batteries.
- Battery chemicals can cause a rash. If the batteries leak, clean the battery compartment with a cloth. If chemicals touch your skin then wash it immediately.
- Do not mix old and new batteries.
- Do not mix alkaline, standard (carbon-zinc) or rechargeable (NiCd, NiMH, etc.) batteries.
- Do not continue using the remote if it gets warm or hot.
- Call our Support Center immediately on the support website.

## Remote control range information

- The remote control can work at a distance of up to 26 feet (792.5 cm) in front of the TV set.
- It can work at a 30 degree horizontal or vertical angle.

## Pairing the remote control

1. Pair the remote to the TV after you power it on for the first time, there will be instructions on how to pair the remote.
2. If your remote fails to pair with TV, keep the remote within 10 feet (304.8 cm) from the TV. You can choose one of the following ways to pair:
  - Method 1: While holding [  ] button, press and hold [  ] button for 3 seconds.
  - Method 2: Press and hold [ MENU ] / [  ] button at least 3 seconds to start pairing.**NOTE:** For some remotes, it can only function after the TV software is updated.
3. If the remote pairs successfully, a confirmation will display on the screen. If it does not pair successfully, an unsuccessful message will display. Repeat step 2, or you can press [  ] button to select **Settings > Remotes & Accessories > Bluetooth** to **On**.

### NOTE:

- If an unknown error occurs with the remote, it could have been caused by interference. Try to remove what's causing the interference and pair the remote again.
- If an unknown error occurs with the remote control while the battery power is normal, you can take out the batteries and press any key for 1~2 seconds, and insert them back. The remote control can work normally.
- The remote cannot be paired to the TV while the TV is in the standby mode.

### Step 4. Power on the TV

Connect your power cord to the TV and plug it into a power outlet.  
Your TV will display a launch screen showing the Hisense logo.

### Step 5. Complete the first-time setup

The first time you turn on your TV, there is a guided setup to make it easy to connect your TV to the Internet and complete the setup of your TV.

### Step 6. Establish a network connection

- 1. Press the [ ⚙️ ] button on the remote, and select **Settings** to enter the Settings menu.
- 2. Select **Network & Internet**.

#### Establish a wired network connection

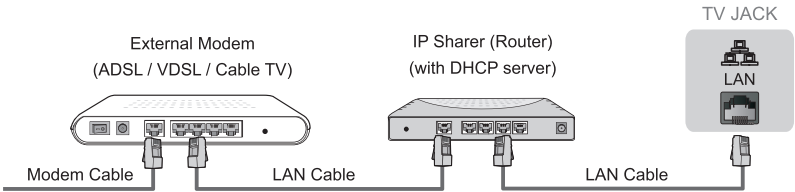

#### Establish a wireless network connection

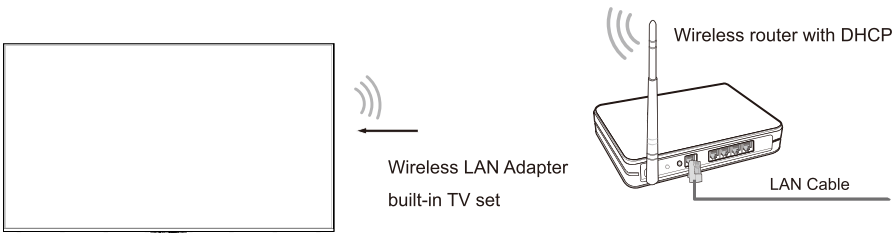

### And setup is done, congratulations!

Now that you've completed the first-time setup, enjoy your TV!

# Troubleshooting

If you are having trouble with your TV, first try turning it off and on again. If this does not fix the problem, check the tips in the following table. If your problem is not listed in the following table, then contact us at one of the phone numbers on page before.

Issues	Possible solutions
No sound or picture	<ul style="list-style-type: none"><li>• Check if the power cord is plugged into a powered AC outlet.</li><li>• Press the Power button on the remote control to activate the unit from 'Standby' mode.</li><li>• Check to see if the LED light is on or not. If it is, then the TV is receiving power.</li></ul>
I have connected an external source to my TV and I get no picture and/or sound.	<ul style="list-style-type: none"><li>• Check for the correct output connection on the external source and for the correct input connection on the TV.</li><li>• Make sure you have made the correct selection for the input mode for the incoming signal.</li></ul>
When I turn on my TV, there is a delay for a few seconds before the picture appears. Is this normal?	<ul style="list-style-type: none"><li>• Yes, this is normal. The TV is initializing and searching for previous setting information.</li></ul>
The picture is normal but there is no sound	<ul style="list-style-type: none"><li>• Check the volume settings.</li><li>• Check if 'Mute' mode is set to On.</li></ul>
Sound but no picture or black and white picture	<ul style="list-style-type: none"><li>• If the picture is black and white, unplug the TV from the AC outlet and replug it after 60 seconds.</li><li>• Check that the Color is set to 50 or higher.</li><li>• Try different TV channels.</li></ul>
The sound and/or picture is distorted or appears wavy	<ul style="list-style-type: none"><li>• An electric appliance may be affecting the TV. Turn off any appliances that are nearby and move it farther away from the TV.</li><li>• Insert the power plug of the TV set into another power outlet.</li></ul>
The sound and picture is blurry or cuts out	<ul style="list-style-type: none"><li>• If using an external antenna, check the direction, position and connection of the antenna.</li><li>• Adjust the direction of your antenna or reset or fine tune the channel.</li></ul>
A horizontal or vertical stripe appears on the picture and/or the picture is shaking	<ul style="list-style-type: none"><li>• Check if there is an appliance or electric tool nearby that is causing interference.</li></ul>
The plastic cabinet makes a "clicking" type of sound	<ul style="list-style-type: none"><li>• The 'click' sound can occur when the temperature of the television changes. This change causes the television cabinet to expand or contract, which makes the sound. This is normal and the TV is OK.</li></ul>
The remote control does not work	<ul style="list-style-type: none"><li>• Confirm that TV still has power and is operational.</li><li>• Change the batteries in the remote control.</li><li>• Check if the batteries are correctly installed.</li></ul>

# Product specifications

Model Name		55U8QG / 55U88QG
Dimension (W × H × D)	Without Stand	48.4 × 28.1 × 1.9 inches (1 229 × 714 × 47 mm)
	With Stand	48.4 × 31.0 × 11.4 inches / 48.4 × 29.4 × 11.4 inches (1 229 × 788 × 290 mm) / (1 229 × 748 × 290 mm)
Weight	Without Stand	39.5 lbs (17.9 kg)
	With Stand	51.8 lbs (23.5 kg)
TV Stand Width(W × D)		15.7 × 11.4 inches (400 × 290 mm)
Active Screen Size (Diagonal)		54.6 inches (138.7 cm)
Screen Resolution		3840 × 2160
Audio Power		2×10 W+2×5 W+20 W+2×8 W
Power consumption		220 W
Power Supply		100-240 V~ 50/60 Hz
Connectivity		Built-in Wireless feature (2x2, three band)
Receiving Channels		VHF: 2 - 13, UHF: 14 - 69, CATV: 1 - 125 Digital Terrestrial Broadcast (8VSB): 2 - 69 Digital cable (64/256 QAM): 1 - 135 Next-Gen TV (QPSK-4096QAM): 2-36
Wireless LAN Module specifications	Frequency Range	2.4-2.4835 GHz 5.15-5.85 GHz 5.9-6.425 GHz
	Output Power (Max.)	2.4-2.4835 GHz 17 dBm 5.15-5.25 GHz 14 dBm 5.25-5.35 GHz(DFS Band) 14 dBm 5.49-5.71 GHz(DFS/TPC Band) 14 dBm 5.725-5.85 GHz(for Non EU) 14 dBm 5.9-6.425 GHz 14 dBm
	Modulation Type	IEEE 802.11 a/b/g/n/ac/ax
	Version/Profiles	Bluetooth 5.3
Bluetooth Module specifications	Frequency Range	2.4-2.4835 GHz
	Output Power (Max.)	2.4-2.4835 GHz, Class1, 6 dBm
	Modulation Type	GFSK, π/4-DQPSK and 8-DPSK
Tuner Type		Frequency synthesized
Receiving Systems		Analog: NTSC, PAL M/N Digital: ATSC 1.0/Next-Gen TV/QAM on cable, ISDB-T, DVB-T2(6M)
Operating Temperature		41 °F - 95 °F(5 °C - 35 °C)
Operating Humidity		20 % to 80 % non-condensing
Storage Temperature		5 °F to 113 °F(-15 °C to 45 °C)
Storage Humidity		10 % to 70 %, non-condensing

**NOTE:** "Receiving Systems" may differ depending on your model/country/region.

**Disclaimer:** All products, product specifications, and data are subject to change without notice to improve reliability, function, design or otherwise.

Model Name		65U8QG / 65U88QG	75U8QG / 75U88QG
Dimension (W × H × D)	Without Stand	57.0 × 33.0 × 1.8 inches (1 448 × 838 × 45 mm)	65.7 × 37.9 × 1.8 inches (1 670 × 963 × 46 mm)
	With Stand	57.0 × 36.0 × 11.4 inches (1 448 × 914 × 290 mm) / 57.0 × 34.4 × 11.4 inches (1 448 × 874 × 290 mm)	65.7 × 40.7 × 13.4 inches (1 670 × 1 035 × 340 mm) / 65.7 × 39.2 × 13.4 inches (1 670 × 995 × 340 mm)
Weight	Without Stand	53.8 lbs (24.4 kg)	76.1 lbs (34.5 kg)
	With Stand	64.4 lbs (29.2 kg)	89.3 lbs (40.5 kg)
TV Stand Width(W × D)		15.7 × 11.4 inches (400 × 290 mm)	15.7 × 13.4 inches (400 × 340 mm)
Active Screen Size (Diagonal)		64.5 inches (163.8 cm)	74.5 inches (189.3 cm)
Screen Resolution		3840 × 2160	
Audio Power		2×10 W+2×8 W+20 W+2×8 W	2×15 W+2×8 W+20 W+2×8 W
Power consumption		310 W	330 W
Power Supply		100-240 V~ 50/60 Hz	
Connectivity		Built-in Wireless feature (2x2, three band)	
Receiving Channels		VHF: 2 - 13, UHF: 14 - 69, CATV: 1 - 125 Digital Terrestrial Broadcast (8VSB): 2 - 69 Digital cable (64/256 QAM): 1 - 135 Next-Gen TV (QPSK-4096QAM): 2-36	
Wireless LAN Module specifications	Frequency Range	2.4-2.4835 GHz 5.15-5.85 GHz 5.9-6.425 GHz	
	Output Power (Max.)	2.4-2.4835 GHz 17 dBm 5.15-5.25 GHz 14 dBm 5.25-5.35 GHz(DFS Band) 14 dBm 5.49-5.71 GHz(DFS/TPC Band) 14 dBm 5.725-5.85 GHz(for Non EU) 14 dBm 5.9-6.425 GHz 14 dBm	
	Modulation Type	IEEE 802.11 a/b/g/n/ac/ax	
Bluetooth Module specifications	Version/Profiles	Bluetooth 5.3	
	Frequency Range	2.4-2.4835 GHz	
	Output Power (Max.)	2.4-2.4835 GHz, Class1, 6 dBm	
		GFSK, π/4-DQPSK and 8-DPSK	
Tuner Type		Frequency synthesized	
Receiving Systems		Analog: NTSC, PAL M/N Digital: ATSC 1.0/Next-Gen TV/QAM on cable, ISDB-T, DVB-T2(6M)	
Operating Temperature		41 °F - 95 °F(5 °C - 35 °C)	
Operating Humidity		20 % to 80 % non-condensing	
Storage Temperature		5 °F to 113 °F(-15 °C to 45 °C)	
Storage Humidity		10 % to 70 %, non-condensing	

**NOTE:** "Receiving Systems" may differ depending on your model/country/region.

**Disclaimer:** All products, product specifications, and data are subject to change without notice to improve reliability, function, design or otherwise.

Model Name		85U8QG / 85U88QG	100U8QG / 100U88QG
Dimension (W × H × D)	Without Stand	74.6 × 43.0 × 1.9 inches (1 894 × 1 092 × 47 mm)	87.8 × 50.5 × 3.2 inches (2 229 × 1 282 × 82 mm)
	With Stand	74.6 × 44.3 × 15.7 inches (1 894 × 1 126 × 400 mm) / 74.6 × 45.9 × 15.7 inches (1 894 × 1 166 × 400 mm)	87.8 × 51.9 × 18.9 inches (2 229 × 1 317 × 480 mm)
Weight	Without Stand	104.5 lbs (47.4 kg)	136.7 lbs (62.0 kg)
	With Stand	120.4 lbs (54.6 kg)	140.0 lbs (63.5 kg)
TV Stand Width(W × D)		17.3 × 15.7 inches (440 × 400 mm)	68.3 × 18.9 inches (1 735 × 480 mm)
Active Screen Size (Diagonal)		84.5 inches (214.7 cm)	99.5 inches (252.7 cm)
Screen Resolution		3840 × 2160	
Audio Power		2×15 W+2×8 W+20 W+2×8 W	2×15 W+2×8 W+20 W+2×8 W
Power consumption		400 W	500 W
Power Supply		100-240 V~ 50/60 Hz	
Connectivity		Built-in Wireless feature (2x2, three band)	
Receiving Channels		VHF: 2 - 13, UHF: 14 - 69, CATV: 1 - 125 Digital Terrestrial Broadcast (8VSB): 2 - 69 Digital cable (64/256 QAM): 1 - 135 Next-Gen TV (QPSK-4096QAM): 2-36	
Wireless LAN Module specifications	Frequency Range	2.4-2.4835 GHz 5.15-5.85 GHz 5.9-6.425 GHz	
	Output Power (Max.)	2.4-2.4835 GHz 17 dBm 5.15-5.25 GHz 14 dBm 5.25-5.35 GHz(DFS Band) 14 dBm 5.49-5.71 GHz(DFS/TPC Band) 14 dBm 5.725-5.85 GHz(for Non EU) 14 dBm 5.9-6.425 GHz 14 dBm	
	Modulation Type	IEEE 802.11 a/b/g/n/ac/ax	
Bluetooth Module specifications	Version/Profiles	Bluetooth 5.3	
	Frequency Range	2.4-2.4835 GHz	
	Output Power (Max.)	2.4-2.4835 GHz,Class1,6 dBm	
	Modulation Type	GFSK,π/4-DQPSK and 8-DPSK	
Tuner Type		Frequency synthesized	
Receiving Systems		Analog: NTSC, PAL M/N Digital: ATSC 1.0/Next-Gen TV/QAM on cable, ISDB-T, DVB-T2(6M)	
Operating Temperature		41 °F - 95 °F(5 °C - 35 °C)	
Operating Humidity		20 % to 80 % non-condensing	
Storage Temperature		5 °F to 113 °F(-15 °C to 45 °C)	
Storage Humidity		10 % to 70 %, non-condensing	

**NOTE:** "Receiving Systems" may differ depending on your model/country/region.

**Disclaimer:** All products, product specifications, and data are subject to change without notice to improve reliability, function, design or otherwise.

# Certification and compliance

**NOTE:** The following warnings only apply to products with such certification.

This device complies with Part 15 of the FCC Rules. Operation is subject to the following two conditions: (1) This device may not cause harmful interference, and (2) This device must accept any interference received, including interference that may cause undesired operation.

**Note:** This equipment has been tested and found to comply with the limits for a Class B digital device, pursuant to Part 15 of the FCC Rules. These limits are designed to provide reasonable protection against harmful interference in a residential installation. This equipment generates, uses, and can radiate radio frequency energy and, if not installed and used in accordance with the instructions, may cause harmful interference to radio communications. However, there is no guarantee that interference will not occur in a particular installation. If this equipment does cause harmful interference to radio or television reception, which can be determined by turning the equipment off and on, the user is encouraged to try to correct the interference by one or more of the following measures:

- Reorient or relocate the receiving antenna.
- Increase the separation between the equipment and receiver.
- Connect the equipment into an outlet on a circuit different from that to which the receiver is connected.
- Consult the dealer or an experienced radio/TV technician for help.

The manufacturer is not responsible for any radio or TV interference caused by unauthorized modifications to this equipment. Such modifications could void the user's authority to operate the equipment.

This equipment complies with FCC radiation exposure limits set forth for an uncontrolled environment. This equipment should be installed and operated with minimum distance of [20] cm between the radiator and your body. This transmitter must not be co-located or operating in conjunction with any other antenna or transmitter.

This device contains licence-exempt transmitter(s)/receiver(s) that comply with Innovation, Science and Economic Development Canada's licence-exempt RSS(s). Operation is subject to the following two conditions:

- (1) This device may not cause interference.
- (2) This device must accept any interference, including interference that may cause undesired operation of the device.

This equipment complies with radio frequency exposure limits set forth by the Innovation, Science and Economic Development Canada for an uncontrolled environment. This equipment should be installed and operated with a minimum distance of 20 cm between the device and the user or bystanders.

This device must not be co-located or operating in conjunction with any other antenna or transmitter.

## Declaration of conformity

Trade Name: Hisense

Model: 55U8QG / 55U88QG / 65U8QG / 65U88QG / 75U8QG / 75U88QG / 85U8QG / 85U88QG / 100U8QG / 100U88QG

Responsible Party: Hisense USA Corporation

Service Address: 105 Satellite BLVD Suite I, Suwanee, GA 30024

Service Phone Number: 1-888-935-8880



Dolby, Dolby Vision, Dolby Atmos, and the double-D symbol are registered trademarks of Dolby Laboratories Licensing Corporation. Dolby Vision IQ is a trademark of Dolby Laboratories Licensing Corporation. Manufactured under license from Dolby Laboratories. Confidential unpublished works. Copyright © 2012-2024 Dolby Laboratories. All rights reserved.



FOR DTS PATENTS, SEE [HTTP://XPERI.COM/DTS-PATENTS/](http://xperi.com/dts-patents/). MANUFACTURED UNDER LICENSE FROM DTS, INC. AND ITS AFFILIATES. DTS, DTS:X, THE DTS:X LOGO, VIRTUAL:X, AND THE DTS VIRTUAL:X LOGO ARE REGISTERED TRADEMARKS OR TRADEMARKS OF DTS, INC. AND ITS AFFILIATES IN THE UNITED STATES AND/OR OTHER COUNTRIES. © DTS, INC. AND ITS AFFILIATES. ALL RIGHTS RESERVED.



Manufactured under license from IMAX Corporation. IMAX® is a registered trademark of IMAX Corporation in the United States and/or other countries. For DTS patents, see <http://patents.dts.com>. Manufactured under license from DTS Licensing Limited. DTS and the DTS logo are registered trademarks or trademarks of DTS, Inc. in the United States and other countries. © 2020 DTS, Inc. ALL RIGHTS RESERVED.



The terms HDMI, HDMI High-Definition Multimedia Interface, HDMI Trade dress and the HDMI Logo are trademarks or registered trademarks of HDMI Licensing Administrator, Inc.



## Environmental protection

This mark indicates that this product should not be disposed together with other domestic garbage, to avoid damage to the environment or human health due to the disposal of uncontrolled waste. Recycle it responsibly for promoting the sustainable reuse of material resources. To return your used device, please use the return systems available in your location or contact the vendor where you purchased your product they could take this product for recycling and protection of the environment.

©2024. All rights reserved. Hisense and the Hisense logo are registered trademarks of Hisense. Other brand and product names are registered trademarks of their respective owners.

## U88QG

### Mini-LED QLED AI TV 165Hz – Google TV

The Hisense U88QG AI TV redefines entertainment with Mini-LED PRO and Quantum Dot technology, delivering unparalleled brightness, colour, and detail. A 165Hz refresh rate with Game Mode Ultra, VRR (48Hz–165Hz), AMD FreeSync™ Premium Pro, and ALLM ensures ultra-smooth gaming. 5,000 nits peak brightness and Full Array Local Dimming provide stunning contrast, while Dolby Atmos 4.1.2 with a built-in subwoofer immerses you in cinematic sound. Level up your experience with the U88QG AI TV!



#### Mini-LED PRO

Smaller LED's allow for more of them to be incorporated into our back-light technology. This leads to the delivery of superior brightness, richer colours, and sharper details compared to conventional LED TVs.

#### 165Hz

#### 165Hz Refresh Rate

Whether it's sports, action movies or pure gaming, this high frame rate greatly reduces motion blur to reproduce a clearer picture.



#### Game Mode Ultra

Serious gamers wanted! With a winning combination of technology, 165Hz Game Mode Ultra is the one to beat. A variable refresh rate from 48Hz to 165Hz ensures that your console and PC gaming will meet any opponent head on. AMD FreeSync™ Premium Pro and Auto Low Latency Mode virtually eliminate screen tearing and controller input lag. Dominate the game – it's time to level up!



#### Full Array Local Dimming

Equipped with dimming zones combined with state-of-the-art video processing, the results deliver a striking contrast with intense black levels and vibrant colour reproduction.



#### Dolby Atmos Sound (4.1.2 Channel with built-in Subwoofer);

Elevate your auditory experience with Dolby Atmos, an award-winning audio enhancement that reveals details you've never noticed before. Take your movie nights and gaming sessions to the next level with a 4.1.2 channel system, featuring four side speakers, two upward-firing speakers, and a built-in subwoofer.



#### QLED

Quantum Dot Wide Colour Gamut technology reproduces over a billion colour combinations for a wider spectrum of colours for true to life images.



#### Hisense AI TV

Hisense Hi-View AI Engine PRO processor enhances every frame with advanced scene recognition, optimizing skin tones, graphics, and contrast for lifelike visuals. It also intelligently enhances sound and energy efficiency for a truly immersive experience.



#### High Brightness Level (up to 5,000 nits)

With a peak brightness of up to 5,000 nits, Hisense TVs deliver a superior viewing experience, even in well-lit rooms with abundant lighting, while also enhancing details in darker scenes for a more immersive movie and gaming experience.



#### Anti-Reflection PRO Screen

The Anti-Reflection Screen reduces distractions by minimizing reflections, decreasing unwanted glare by up to 56% compared to ordinary screens. Enjoy a clear viewing experience during midday matches and evening movies without interference from sunlight or lamp reflections.



#### Total HDR Solution

Hisense TVs have taken the sensible approach to HDR with support for all major formats, including Dolby Vision, HDR10, HDR10+, and HLG. Never worry about subpar video quality or compatibility again.

	55U88QG	65U88QG	75U88QG	85U88QG	100U88QG
DISPLAY					
Screen Class	55"	65"	75"	85"	100"
Backlight Source Type	Mini-LED Pro				
PICTURE QUALITY					
Screen Resolution	4K UHD				
QLED-Quantum Dot Colour	QLED Colour				
WCG-Wide Colour Gamut	Yes				
AI PQ Engine	Hi-View Engine Pro				
Peaking Brightness (typical nits)	Up to 5,000 nits				
Full Array Local Dimming	Yes				
Local Dimming Zones	1008	2048	2160	3168	5376
Anti-Reflection PRO Screen	Yes				
Native Refresh Rate	165Hz				
MEMC	Yes				
Aspect Ratio	16:9				
HDR Formats	Dolby Vision, Dolby Vision IQ, HDR10, HDR 10+, HDR10+ Adaptive, HLG				
Film Maker Mode	Yes				
IMAX Enhanced	Yes				
SMART TV					
Smart Platform	Google TV				
Google Assistant	Google Assistant Built-in				
Alexa	Works With Alexa				
Apple Home Kit	Works with Apple HomeKit / Airplay				
Far Field Mic/Hands Free	Yes				
GAMING					
Game Mode	165Hz Game Mode Ultra				
VRR / ALLM	Yes				
Game Bar	Enhanced				
AMD Freesync	Freesync Premium Pro				
Gsync SPD Compatible	Yes				
AUDIO					
Audio Output Power (Watts)	66W	72W	82W	82W	82W
Multi-Channel Audio	4.1.2				
Audio Enhancement	Dolby Atmos				
Soundsend Certified	Yes				
LANGUAGES					
On-screen Display	English, French, Spanish				
POWER					
Power Consumption	220W	310W	330W	400W	500W
Standby Consumption	<0.5W	≤0.5W	≤0.5W	≤0.5W	≤0.5W
CONNECTIVITY					
Wi-Fi Built In	Wifi 6E				
Bluetooth	Yes (5.3)				

	55U88QG	65U88QG	75U88QG	85U88QG	100U88QG
PORTS					
HDMI			3 x HDMI 2.1		
HDMI-CEC, HDMI-ARC			Yes (HDMI-3 eARC)		
Ethernet (LAN)			Yes		
USB-C			Yes		
USB			Yes (1 x 3.0, 1 x 2.0)		
RF Antenna Type			NTSC / Clear QAM/ ATSC 3.0 (NextGen TV)		
RCA Composite Video Input			Yes (Mini Jack)		
L/R Audio Input for Composite			Yes		
Digital Audio Output			Optical		
Earphone / Audio Output			Yes		
OTHER FEATURES					
Noise Reduction			Yes		
Parental Control			Yes		
Sleep Timer			Yes		
WALL MOUNT					
VESA	400 x 400 (M6)	400 x 400 (M6)	600×400 (M8)	600x400 (M8)	800×400 (M8)
Dual Position Stand	Height Adjustable Pedestal Stand	Height Adjustable Pedestal Stand	Height Adjustable Pedestal Stand	Height Adjustable Pedestal Stand	No (Two Legs)
ACCESSORIES					
Remote w/ batteries			Back-Lit Voice Remote with G-Sensor		
Quick Start Guide and/or User Manual			Yes		
Power Cable			Yes		
DIMENSIONS / WEIGHT					
TV Dimensions without the stand (W x H x D)	48.4×28.1×1.9 inch, 1229×714×48 mm	57.0×33.0×1.8 inch, 1448×838×46 mm	65.7×37.9×1.8 inch, 1669×963×46 mm	74.6×43.0×1.9 inch, 1895×1092×48 mm	87.8×50.5×3.2 inch, 2230×1283×81 mm
TV dimensions with the stand lower position (W x H x D)	48.4×29.4×11.4 inch, 1229×747×290 mm	57.0×34.4×11.4 inch, 1448×873×290 mm	65.7×39.2×13.4 inch, 1669×996×340 mm	74.6×44.3×15.7 inch, 1895×1125×399 mm	87.8×51.9×18.9 inch, 2230×1318×480 mm
TV dimensions with the stand upper position (W x H x D)	48.4×31.0×11.4 inch, 1229×787×290 mm	57.0×36.0×11.4 inch, 1448×914×290 mm	65.7×40.7×13.4 inch, 1669×1034×340 mm	74.6×45.9×15.7 inch, 1895×1165×399 mm	NA
TV Stand Width (W x D)	15.7×11.4 inch, 399×290 mm	15.7×11.4 inch, 399×290 mm	15.7×13.4 inch, 399×340 mm	17.3×15.7 inch, 439×399 mm	68.3×18.9 inch, 1735×480 mm
Carton Dimensions (W x H X D)	58.4x33.7×6.8 inch, 1483×856×173 mm	66.9×39.3×6.8 inch, 1699×998×173 mm	77.4×46.3×7.4 inch, 1966×1176×188 mm	86.2×50.4×8.1 inch, 2189×1280×206 mm	94.4×58.7×9.8 inch, 2398×1491×249 mm
TV Weight without the stand	39.5 lb, 17.9 kg	53.8 lb, 24.4 kg	76.1 lb, 34.5 kg	104.5 lb, 47.4 kg	136.7 lb, 62 kg
TV weight with the stand	51.8 lb, 23.5 kg	64.4 lb, 29.2 kg	89.3 lb, 40.5 kg	120.4 lb, 54.6 kg	140 lb, 63.5 kg
Shipping Weight	65.7 lb, 29.8 kg	83.3 lb, 37.8 kg	115.7 lb, 52.5 kg	153.4 lb, 69.6 kg	192.9 lb, 87.5 kg
WARRANTY / UPC					
Warranty			1 Year		
UPC Code	888143022413	888143022369	888143022420	888143022437	888143022444