



GOKIXX 621

Wireless Neckband

Get ready for MORE, for a LIFE of WOW with your all new GOKIXX 621. We strongly recommend you go through this manual entirely before beginning to use the product, as it contains important technical information to ensure a seamless audio experience. It can also be referred to in times of difficulty.

PACKAGE CONTENTS

- 1 x GOKIXX 621
- 1 x Type C Charging Cable
- 2 x Additional Ear Muffs
- 1 x Warranty Card
- 1 x Manual

CHARGING

- Earphones are partially charged. Please ensure you fully charge them before you use them for the first time.
- Plug the Type C cable into the charging port of any USB charging adapter or active computer USB port.
- Charging will start automatically, and the LED indicator will turn red.
- The earphones are fully charged when the LED indicator turns blue for 60s and then turns off.

Note: Charge the earphones at least once every 1 month when they are not in use for a long time.

FUNCTION CONTROLS

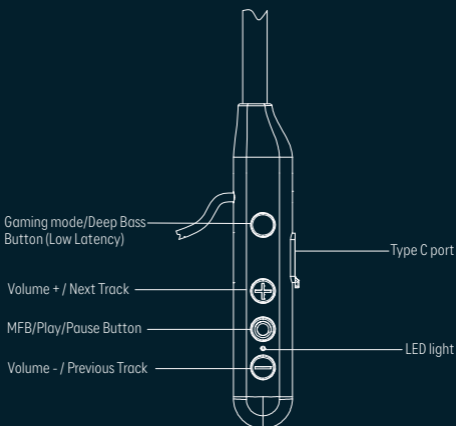

PAIRING DEVICE

Pairing steps for mobile :

- Turn the earphones on by holding the MFB, the blue and red indicator flashes alternately. You have entered into pairing mode.
- Open bluetooth and keep the neckband close to your mobile (1m range).
- Select GOKIXX 621 of the bluetooth devices shown available in your phone. After pairing, the LED indicator will flash blue to indicate the succesful connection.
- GOKIXX 621 will automatically be connected to the paired device, every time the device is switched on in the future.

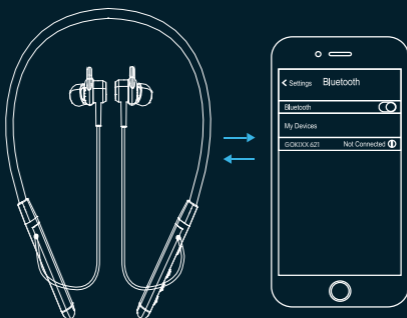

SPECIFICATION

Model	GOKIXX 621
Driver size	10mm
Frequency Range	20Hz-20kHz
Sensitivity	105dB±3dB At 1kHz
Battery Capacity	140mAh
Music Playtime	22 Hours
Charging port	Type C
Input voltage	5V DC, 1A
Fast Charge	10 hours playtime with 10 mins charge
Full Charge	50minutes
Bluetooth	V5.2
Transmission Dist.	10m
Water resistantce	IPX4

HOW TO USE

Power On	Unclip the magnetic buds. Blue LED flash once.
Power Off	Clip the magnetic buds. Red LED flash once.
Answer call	Short press the MFB button
End call	Short press the MFB button
Reject call	Long press the MFB button for 1 sec
Music play/pause	Short press the MFB button
Previous song	Long press the "-" Button
Next song	Long press the "+" Button
Volume up	Short Press the "+" Button
Volume down	Short Press the "-" Button
Deep bass mode	Press the Deep Bass button 2 times (ON/OFF)
Game mode	Press the Gaming mode button once (ON/OFF)
Voice assistant	Press the MFB 2 times to activate Voice assistant
Smart Magnetic Buds Control	Clip your magnetic earbuds and your neckband will be OFF automatically to save battery. When you unclip them it will be ON immediately.

RESET

Press and hold the "+" and "-" buttons simultaneously for 5 seconds to clear the previous list of connected devices

SMART MAGNETIC BUDS

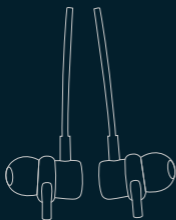

POWER ON

Everytime you unclip the buds, your GOKIXX 621 is switching on and getting automatically connected to the previous device.



POWER OFF

Everytime you clip the buds, your GOKIXX 621 is getting disconnected in order to save battery.

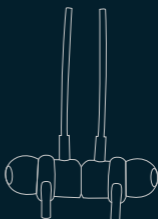

SAFETY INTRODUCTIONS

- 1 Please read, follow and keep these instructions.
Heed all warnings on the product and in the instructions for use.
- 2 Stop using this product immediately if it causes discomfort or pain. When using this product, it is recommended that you limit the volume to help avoid causing harm to your ears and danger resulting from being unable to hear what is going on around you.
- 3 Keep the device out of extreme heat and humidity.
Do not use the device near water, such as sinks, bathtubs, swimming pools, washing machines, tubs of water, etc.
- 4 Observe all signs and instructions that require an electrical device or radio product to be switched off in designated areas, such as petrol/refueling stations, hospitals, blasting areas, potentially explosive atmospheres, and aircraft.
- 5 Using earphones while driving can distract you and increase the likelihood of an accident. If driving conditions demand it (such as bad weather, high traffic density, presence of children in the car, difficult road conditions), pull off the road and park before making or answering calls.
- 6 Battery life may differ depending on personal habits.

WARNING

- To prevent potential hearing damage, do not listen to high volume levels for long periods.
- Do not turn the volume up too high; doctors warn against prolonged exposure to high volumes.
- Stop using the product or lower the volume if you feel your ears ringing. Prolonged listening at high volumes could lead to hearing damage.